

METAGLAS® Bolt-on sight glass flange for sterile applications
(For sight glass luminaires: Types USL-33, ESL53 or BKVLR-A)

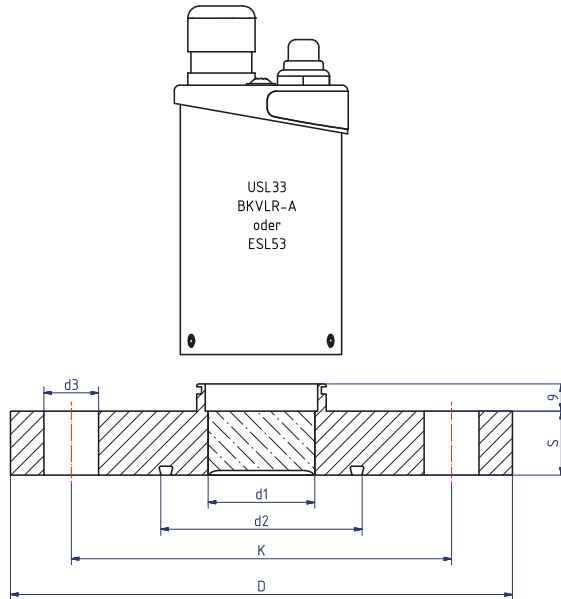

Applications

- Aseptic and sanitary applications
- Mating to welding neck flat face flange
- Weld in base flange DIN 28117 or similar

Material certificates

- Certificate of Conformity to EN 10204-3.1 or 3.2

Advantages

- Security against total failure
- Compact design
- Easy cleaning – verifiable gap
- Suitable for CIP and SIP cleaning*

Approvals

- TÜV component approval for use as pressure vessel part to pressure vessel codes (matl. of const 1.4462)

Operating conditions

Pressure: -1 to 16 bar
Temperature: See table

Ring materials Temperature (TS)

Ring materials	Temperature (TS)
1.4462	-30°C to +280°C
2.4602	-80°C to +300°C
2.4605	-80°C to +300°C
2.4610	-80°C to +300°C

Approvals and technical data

- Pressure Equipment Directive 2014/68/EU, Module H (DIN/EN/ISO 9001)
- AD2000 Standards W0/TRD 100
- Sight glass fused to metal conforming to DIN 7079
- Materials to VdTÜV specifications and the DIN/EN designated standards
- Glass: borosilicate to DIN 7080 / DIN 7079

Important

Only for use with parallel, flat face flange without seal recess. Maximum torque 20 Nm. We therefore recommend the use of Belleville spring washers, 2 pcs. for each connection hole.

For further technical information, see data sheets USL33/ESL53 or BKVLR-A

Nominal size	Nominal pressure	D	K	S	d1	d2	d3	Number of bore holes	O-ring	Spring washers
50	16	165	125	21	35	66	18	4	58,74 x 3,53	31,5/16,3 x 1,25
65	16	185	145	23	35	86	18	4	78,97 x 3,53	31,5/16,3 x 1,25

*For more detailed information, please read the maintenance instruction.